



**FORTUNE & COATES**

The People's Estate Agent

<https://www.fortuneandcoates.co.uk>



**1 Sadlers Mead, Harlow, CM18 6HG**

**Asking price £375,000**

Located just off of Tumblers Road, is this large and spacious four bedroom end of terrace chain free family home. To the ground floor you have an entrance hallway with doors leading to the kitchen, utility room with doors to a W/C and out to the rear garden, spacious lounge with dual aspect windows. To the first floor you have four double bedrooms and a modern family bathroom.

Externally, you have a large rear garden with a patio area for seating and space for a shed to the side of the property.

Sadlers Mead, Harlow is close to junior and senior schools, local shopping precinct with shops and amenities and within easy reach of the M11 and Harlow Town centre with an array of supermarkets, shops, restaurants and leisure facilities. Harlow Town Train station is also nearby and has direct links to London, Cambridge and Stanstead Airport.

Living Room 11'3" x 19'4" (3.43 x 5.91)

Kitchen 9'8" x 12'8" (2.96 x 3.88)

Utility 7'9" x 9'10" (2.37 x 3.01)

Bedroom 14'9" x 9'5" (4.51 x 2.89)

Bedroom 11'2" x 9'7" (3.42 x 2.94)

Bedroom 8'9" x 13'0" (2.69 x 3.98)

Bedroom 10'5" x 6'0" (3.18 x 1.85)

AGENT NOTE: The information provided about this property does not constitute or form part of an offer or contract, nor may it be regarded as representations. All interested parties must verify accuracy and your solicitor must verify tenure/lease information, fixtures & fittings and, where the property has been extended/converted, planning/building regulation consents. All dimensions are approximate and quoted for guidance only as are floor plans which are not to scale and their accuracy cannot be confirmed. Reference to appliances and/or services does not imply that they are necessarily in working order or fit for the purpose.



Floor Plan

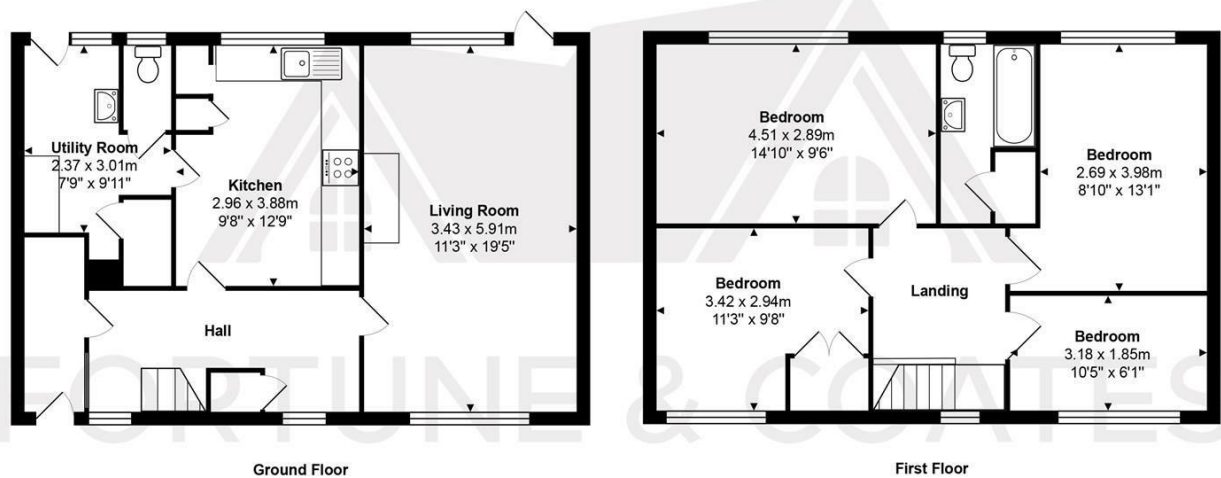

Total Area: approx. 105.2 m<sup>2</sup> ... 1132 ft<sup>2</sup>

THE FLOORPLAN IS FOR ILLUSTRATIVE PURPOSES ONLY AND IS NOT TO SCALE.  
Measurements and features are approximate and may differ from the actual property. Verify all details independently; no liability is accepted for errors or omissions.

Property marketing provided by [www.fotomarketing.co.uk](http://www.fotomarketing.co.uk)

Area Map

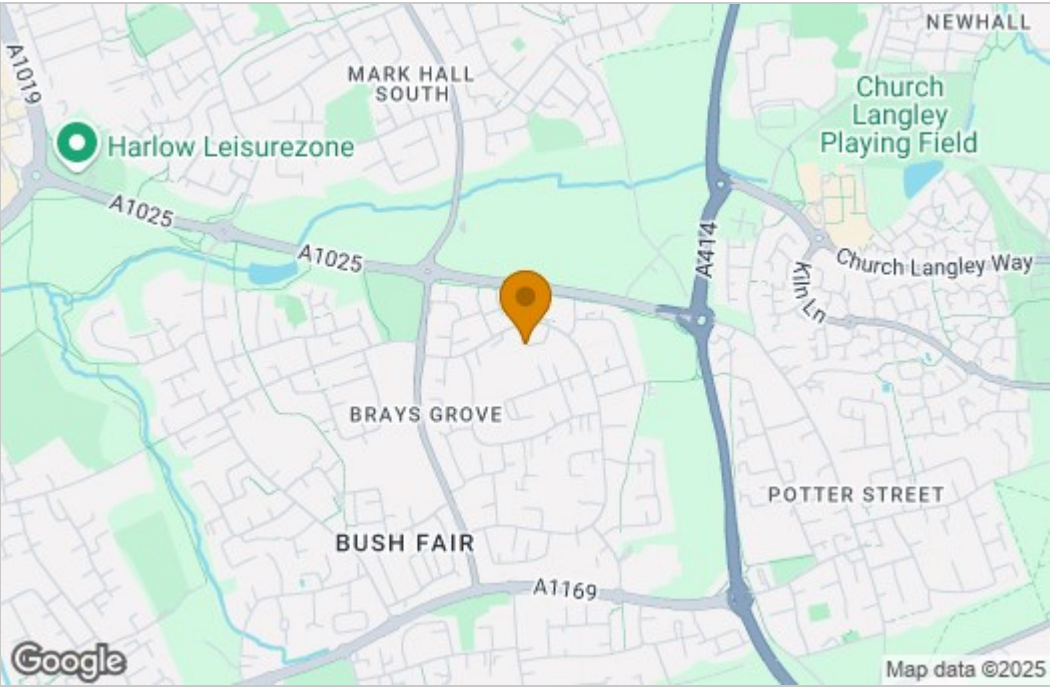

Energy Efficiency Graph

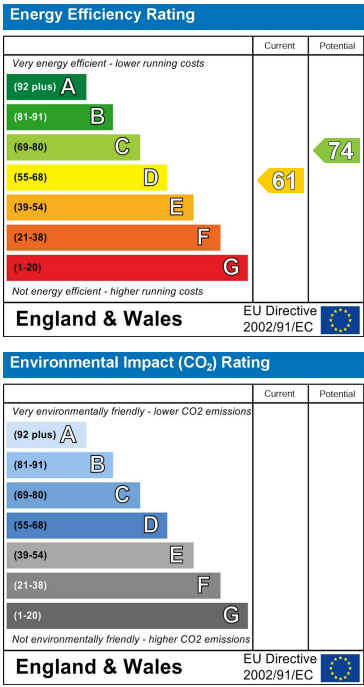

These particulars, whilst believed to be accurate are set out as a general outline only for guidance and do not constitute any part of an offer or contract. Intending purchasers should not rely on them as statements of representation of fact, but must satisfy themselves by inspection or otherwise as to their accuracy. No person in this firm's employment has the authority to make or give any representation or warranty in respect of the property.